

GLUSHU

DO YOU HAVE THE
GUTS TO GLUE?

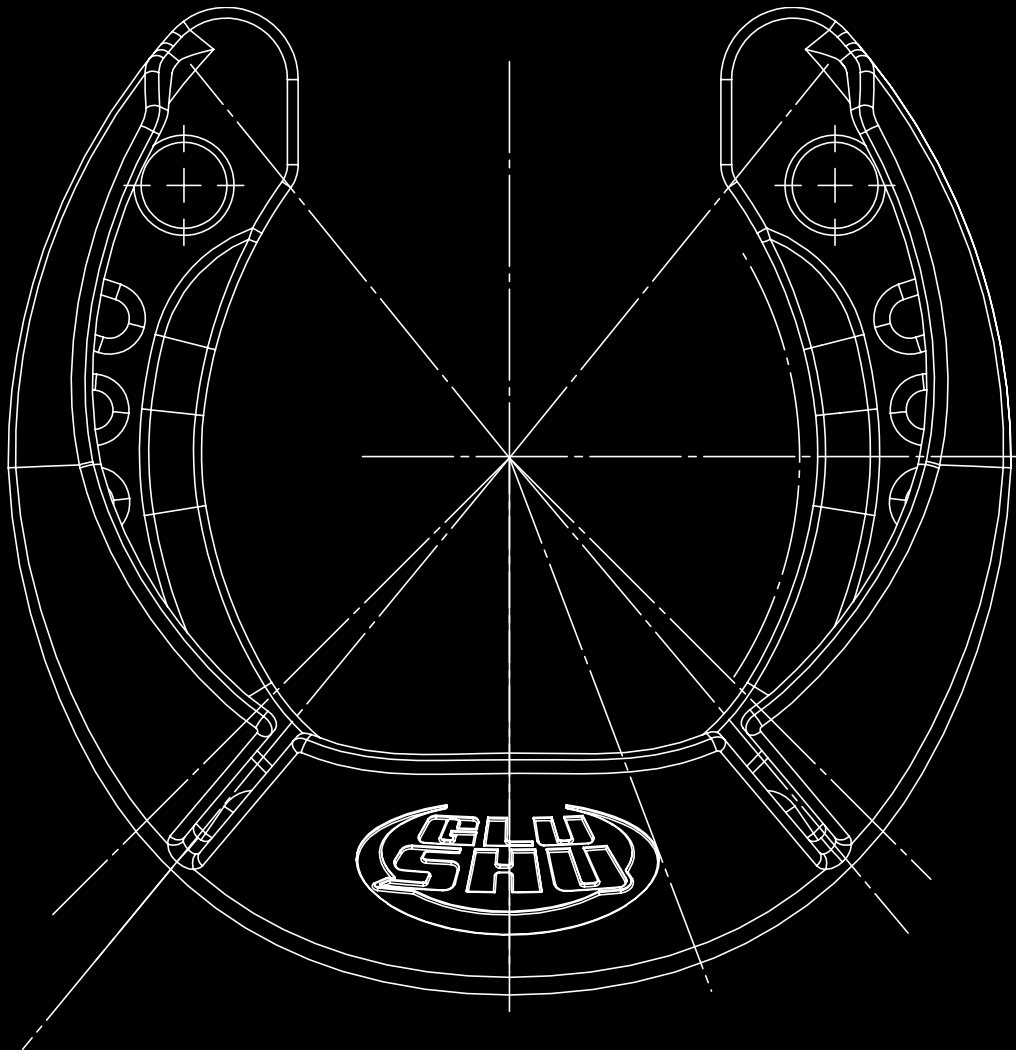



WHAT IS THE GLUSHU?

INTRODUCTION

GluShu is a flexible cuff bonded to a specially designed aluminium horse shoe. Also available in a mini version for small horses and foals, and an XL version for draft horses.

This gives the horse a light, hoof supporting, cushioned shoe which eliminates any stress or damage to the horse's hoof and is easy to apply.

GluShus are non invasive, completely eliminating the risk of hoof injury due to nailing. Easy and fast to apply. Available in pairs or kit. A kit includes all the essential equipment needed to glue on a pair of GluShus; 1x GluShu Pair, 1x ShuBond 150cc, 1x Adapter and 4x Mixing tip. Uses a fast acting glue. We strongly advise you to use Glue-U Shubond glue which is specifically designed to be used with GluShu. Simple sizing system & large range of sizes.

WHY USE GLUSHU?

CUSHIONS THE FEET

GluShu is a glue-on shoe with a very similar use compared to normal steel/ aluminium shoes. GluShu can easily be reshaped, grinded, etc... It can be applied in every situation where nailing is difficult, impossible or not wanted. GluShu is glued to the hoof wall. Which means that limitation of hoof mechanism is minor. The cuff allows the shoe to be glued in stages.

No need for any special equipment. Simple sizing system & large range of sizes. No alteration needed. Eliminates the risk of stress when nailing into a thin white line or poor hoof wall. Cushions the feet. The cuff can be used to hold topical medication in place. Prevents further damage to hoof wall. GluShu can also be combined with all Glue-U ShuPack or GluShu inserts combined with ShuDIM or ShuSil.





CUSTOMIZE CAN EASILY BE RESHAPED

With GluShu, shaping is a breeze. But remember, caution is key when working with rubber. Always ensure your safety by avoiding positioning your head directly above the shoe while reshaping it. A tap in the desired area is all it takes to mold GluShu.

GluShu offers a user-friendly design and customizable fit. Upgrade your equine care routine today and experience the difference with GluShu.

USE GLUSHU FOR: EXAMPLE APPLICATIONS



GluShu Front or Hind shoe + front cuff cut out to use as open toe shoe. Heels can also be grinded to round shape for better roll-over.



GluShu front shoe + front cuff cut out to reposition breakpoint for better roll-over. In case needed GluShu ground surface can also be grinded to a round shape.

USE GLUSHU FOR: EXAMPLE APPLICATIONS



GluShu combined with mesh or pad for filling with pad materials. Mesh or pad glued right before application.



GluShu combined with a pad and ShuDIM to reduce as much as possible stress on the sole. The damaged toe is kept open to assure daily disinfection and cleaning.

PREPARATION

GLUSHU

You can reshape the shoe as you would do with a normal aluminium horseshoe.

Good hoof prep is critical to the shoe remaining secure for the complete trim cycle 6-8 weeks.

1

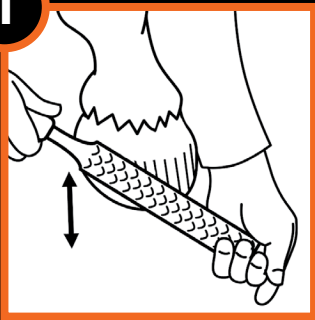

Trim and fine rasp the hoof as normal. Ensure all parts of the hoof where the GluShu will fit have been rasped and dust free (including the heels).

2

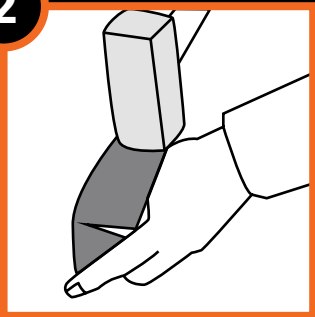

To reshape GluShu, hit the desired area with a hammer.

3

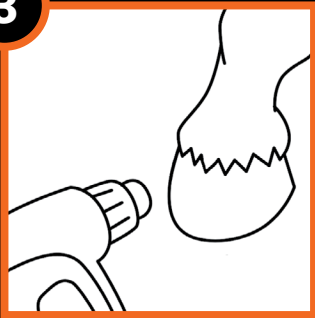

Make sure the hooves are dry. Most glue failure is due to dirt or moisture in the hoof.

PREPARATION

GLUSHU



When using Shufit Glue, express a small amount of glue until it is dark grey before using.

Make sure the glue is warm (25 °C - 30 °C | 77 °F - 86 °F). Also make sure your GluShu is room temperature (20 °C | 68 °F).

STANDARD APPLICATION

PER PAIR OF GLUSHU'S

1x	150cc tube Shufit acrylic glue & mixingtips
1x	Dispenser for shufit (universal with adapter)
1x	Clear roll of hoofwrap



Put a medium bead of Shufit glue around the inside base of the shoe and cuff.

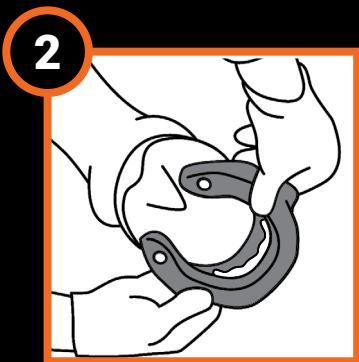

Holding back the side cuffs, slide the shoe onto the hoof, aligning it with the frog and adjust to the correct position.

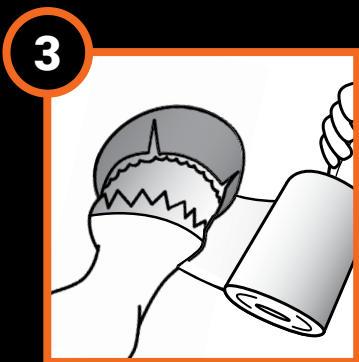

Use hoofwrap to keep the shoe in position while the glue is setting.
Place the foot gently on the ground when the glue has set.

SHUFIX

APPLICATION

Shu Fixation method

For horses who cannot hold their feet off the ground due to soreness. For glueing in severe cold circumstances.

PER PAIR OF GLUSHU'S

1x	150cc tube Shufit acrylic glue & mixingtips
1x	250cc Shufix
1x	Hoof pick to help pull back the cuffs
1x	Dispenser for shufit (universal with adapter)
1x	Clear roll of hoofwrap

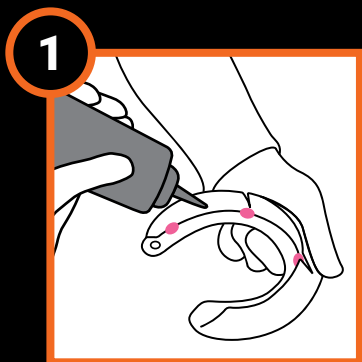

Put four medium beads of Shufix on the inside base of the shoe and cuff.

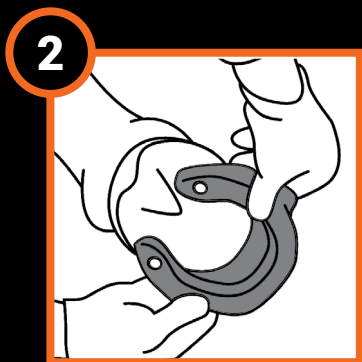

Holding back the side cuffs, aligning it with the frog and adjust to the correct position.

Hold for 30 seconds. Once the Shufix has set, place the hoof on the ground.

SHUFIX

APPLICATION

3

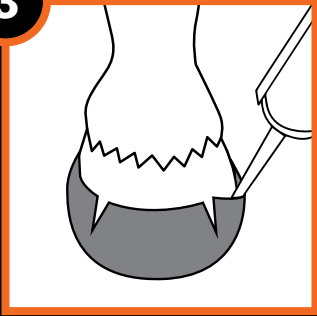

With the hoof on the ground, pull back the cuffs using a hoof pick and backfill inside the cuff with Shufix.

4

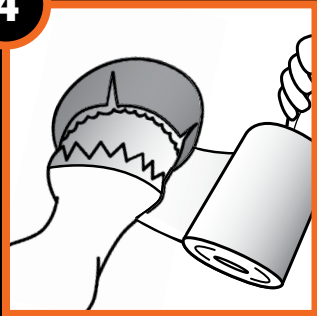

Use hoofwrap to keep the shoe in position while the glue is setting.

5

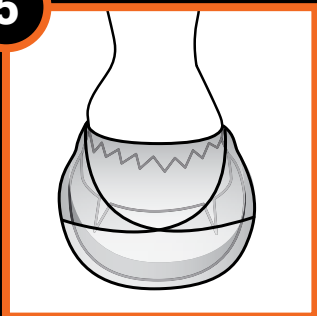

Place the hoof on the ground and leave for a minimum of 10 minutes before removing the hoof wrap.

PRE FIX APPLICATION

Pre Fixation method

For horses who cannot hold their feet off the ground due to soreness. For glueing in severe cold circumstances.

PER PAIR OF GLUSHU'S

1x	150cc tube Shufit acrylic glue & mixingtips
1x	Pre Fix Glue and activator spay (will last 6-10 pairs)
1x	Hoof pick to help pull back the cuffs
1x	Dispenser for shufit (universal with adapter)
1x	Clear roll of hoofwrap

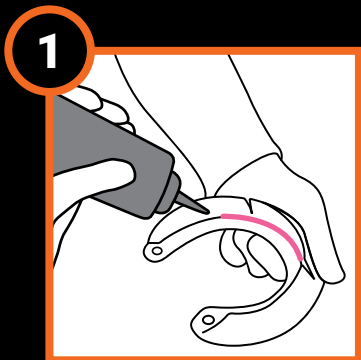

Put a medium bead of Pre Fix CA Glue around the inside base of the shoe and cuff.

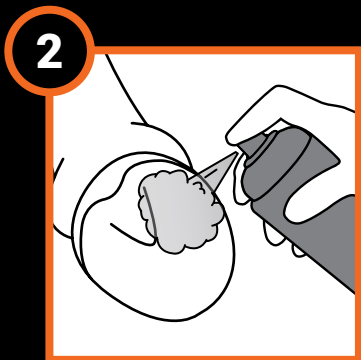

Spray the Pre Fix activator around the base of the hoof.



PRE FIX

APPLICATION

3



Holding back the side cuffs, aligning it with the frog and adjust to the correct position.

Hold for 30 seconds. Once the Pre Fix CA glue has set, place the hoof on the ground.

Warning: Make sure you position the GluShu right because you have 2 seconds before the GluShu is fixed.

4

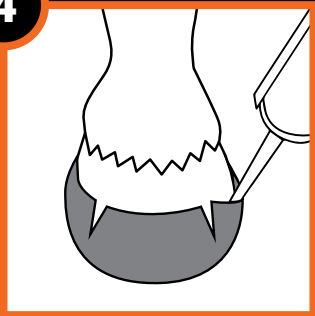

With the hoof on the ground, pull back the cuffs using a hoof pick and backfill inside the cuff with Shufit.

5

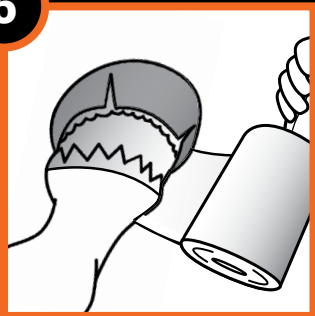

Use hoofwrap to keep the shoe in position while the glue is setting.

6

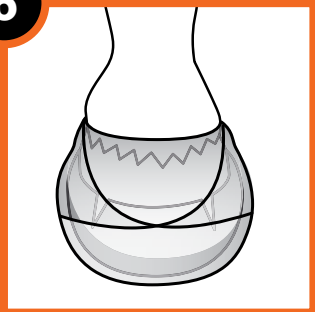

Place the hoof on the ground and leave for a minimum of 10 minutes before removing the hoof wrap.

REMOVAL

DRAWKNIFE

1

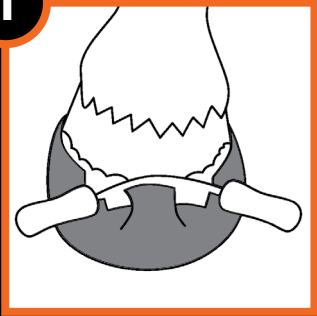

Using a draw knife, cut the cuff from the hoof using downward strokes along the glue line.

2

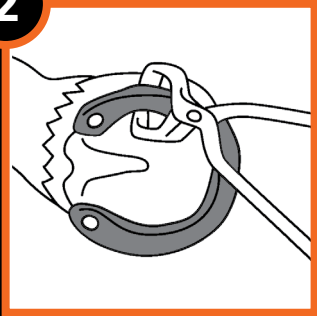

Using nippers, cut the metal shoe from the hoof.

3



Remove any remaining glue or cuff with a rasp or buffer.

PRE FIX
APPLICATION
VIDEO



STANDARD
APPLICATION
VIDEO



MODIFICATION
VIDEO



INSERTS

APPLICATION

PER PAIR OF GLUSHU'S

1x	Set GluShu inserts
1x	Application set of your choice

1

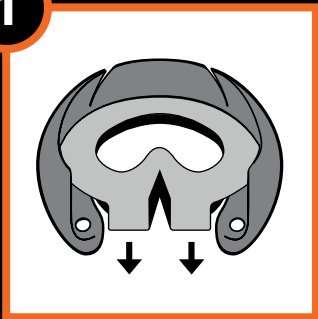

Apply the insert to the GluShu from above with the glue of your choice.

Glue-U CA glue: 10 seconds
Glue-U Shufit: 5 minutes

TIP! Fill with Glue-U pad material for the best support.



CONTACT

GLUE-U

Glue-U USA Inc

215 Church Street
Georgetown
SC 29440 USA

Tel. 1 (816) 305-6984
Tel. 1 (770) 313-4007
E-mail: sales-us@glue-u.com
Website: www.glue-u.com

Glue-U Adhesives BV

Droogdokkeneiland 8
5026 SR Tilburg
The Netherlands

Tel. +31 (0)13 545 31 18
E-mail: sales@glue-u.com
Website: www.glue-u.com